

INTRODUCTION

Thank you for choosing a Yale Digital Lock.

The new Yale Digital Lock uses the latest technology to make life so much easier.

This user manual enables you to operate the product safely and to its full potential.

Be sure to read this completely before using the Yale Digital Lock product.

Unlock your life!

The world's favorite lock



CONTENTS

Safety/Precautions	04
Product Features	05
Components Overview	06
Specifications	07
Identification	08
Quick Menu (Advanced mode)	10
Quick Menu (Normal mode)	12
Configuration	14
Advanced mode	
Change the Master code	14
Register and delete User code	15
Register and delete Fingerprint	16
Register and delete Onetime code	17
Delete All Credentials	18
Lock Setting	19
Register and delete Remote control	20
Register and delete Controller	21
User Code registration User Fingerprint registration	22
Normal mode	
How to Use	23
Unlocking Door with Code	23
Unlocking Door with Fingerprint	23
Locking the door	24
Unlocking the door from the inside	25
Safe Handle Setting	26
Open Door with fake Code	27
External Forced Lock Internal Forced Lock	28
Automatic / Manual Lock Volume	29
Break-in Alarm 3-minute Lock Out Feature	30
Emergency/mechanical key override Product malfunction	31
Resetting Lock to Factory/Default	31
Emergency Power	32
ESPAÑOL	33
PORTUGUÊS	65

Safety Precautions

Please read this carefully

Do not install the digital door lock in an outdoor environment

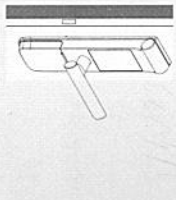

Do not attempt to disassemble the digital door lock by your self. By doing so, you may get an electronic shock and damage the product.

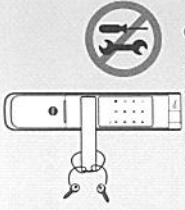

An infant and some users who have unusual fingerprints (those which are difficult to register) may not be registered for fingerprint verification.

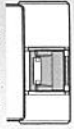

* Scan-type fingerprint modules do not recognize fingerprints with water or foreign materials and set off alarm sounds.

Do not use force with a tool onto the product.

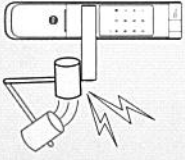

Please keep your Code safely.

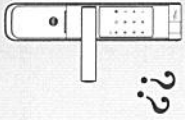

Make sure to lock the door tight when you go out.

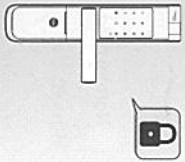

Be careful not to hit the handle as it may cause injuries.

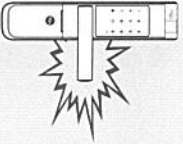

For total peace of mind, please store your back up key in a safe & convenient place after the door installation is complete.



Do not use water and any type of solvent to clean the product such as gasoline or benzene as they can cause damage to electronic circuit, deterioration and or paint peel-off.

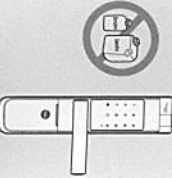

Caution

Make sure to follow the above instructions to avoid any injuries or damages on the properties.

Product Features

1 Alarmed Door Lock

Yale Digital door lock has a built in damage alarm. If the keypad area is damaged an alarm will sound.

2 One-touch Fingerprint Verification Method (Easy Scan)

Easy Scan technology has been applied to conveniently read a fingerprint in one shot without the need to open or close the cover to enter a fingerprint.

3 Electronic Code System

You can open the door conveniently with Code. Yale Digital door lock gives you the freedom and convenience of key-free.

4 Remote control System(Optional)

Use a Remote control to unlock your door "remotely"

5 Emergency power back up

9V battery source is available if your batteries run out.

6 Fake Code

To prevent the Code being exposed, Yale Digital door lock allows you to enter decoy numbers before or after entering your Code

7 Auto Locking

The handle automatically disengages on the outside once you have entered your home, preventing anyone from following you.

Components Overview

Basic Contents

The contents of this product may be subject to change without notice for performance or quality improvement.

Basic Contents

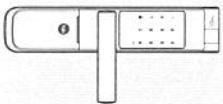

Front (Front Body)

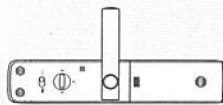

Back (Main Body)

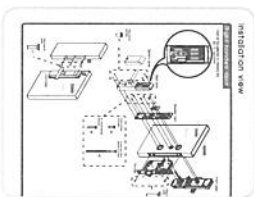

Installation Template



Lock case



Users Guide

4 AA Batteries
Emergency Keys
Striker
Screws

Optional Accessory

- Remote controller
- Remote control module

Specifications

Specifications

Parts	Specifications	Remarks
Front (Front Body)	66mm(W) x 320mm(H) x 25mm(D) Aluminum	Operating temperature : -15~55°C (5~131 °F)
Back (Main Body)	66mm(W) x 320mm(H) x 31mm(D) Aluminum die-casting, Cover(ABS+PC)	
Lever	Aluminum die-casting	
User code	30 different User codes	Up to 30 User code
Fingerprint	20 different fingerprints	Up to 20 fingerprints
Battery	4EA 1.5V AA alkaline batteries (Operating voltage: 4.5 ~ 6 V)	Last up to 1 year (10 times used a day)
Lock case	Steel and SUS430	
Option	Remote Control	Wireless
		Optional

- ※ Battery life may vary depending on temperature, moisture levels, frequency of use and the quality of the batteries.
- ※ Please make sure that all parts are included when purchasing the product.
- ※ Optional products may not be available depending on your country or local dealer.



Packaging of this product can be recycled.

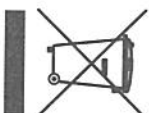

WEEE Note:
Waste electrical products should not be disposed of with household waste. Please recycle where facilities exist. Check your local authority or retailer for recycling advice.

CE

Yale

Identification

Front body

(Front Body, Installation on the outside of the door)

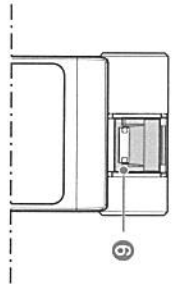
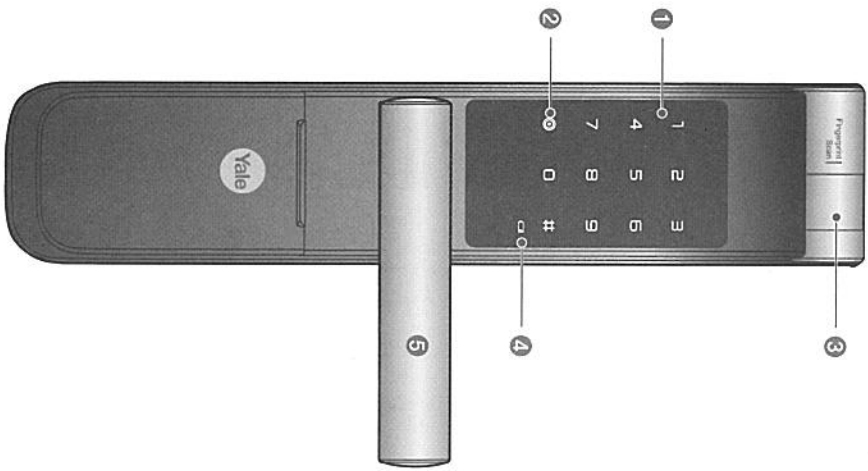

Pull down Emergency Cover

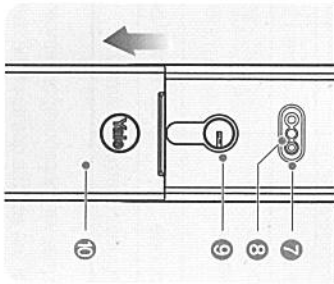

9V Emergency battery (Sold separately)

1	Keypad (10-Key)
2	Wake up Button
3	Fingerprint Cover
4	Battery Change Lamp
5	Lever
6	Fingerprint Sensor
7	Emergency Power Supply Terminal
8	Reset button
9	Emergency Key
10	Emergency Cover

Identification

Main body

(Main Body, Installation on the inside of the door)

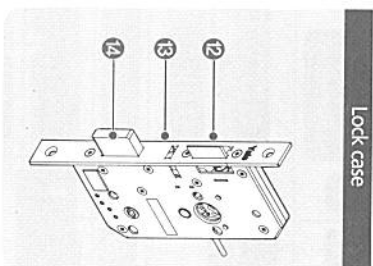
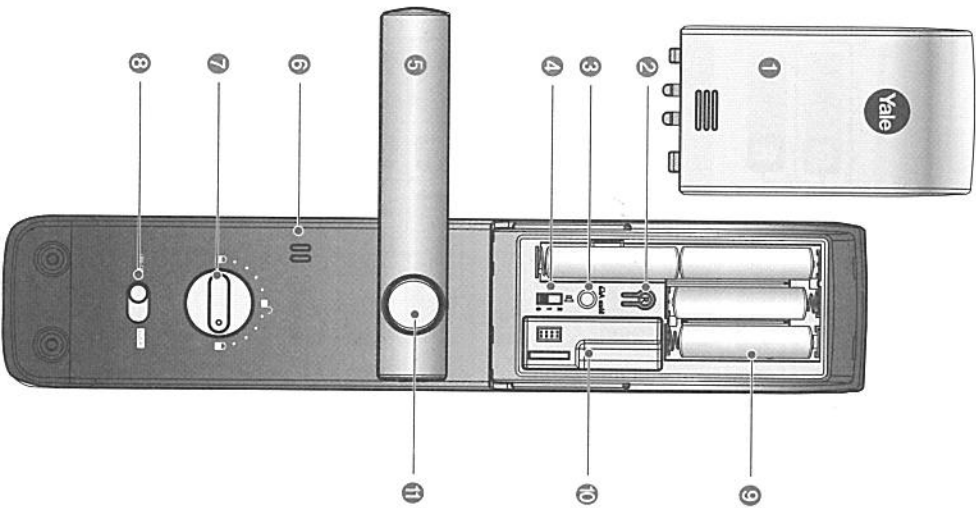

Lock case

1	Battery Cover
2	Registration button
3	Automatic / Manual Lock button
4	Volume Control Switch
5	Lever
6	Speaker
7	Thumb turn knob
8	Internal Forced Lock Switch
9	1.5V AA Alkaline Batteries
10	Slot for Remote control module (Option)
11	Safe handle button
12	Latch Bolt
13	Automatic Locking Sensor
14	Dead Bolt

Quick Menu

Advanced mode

Quick Menu (Advanced mode)

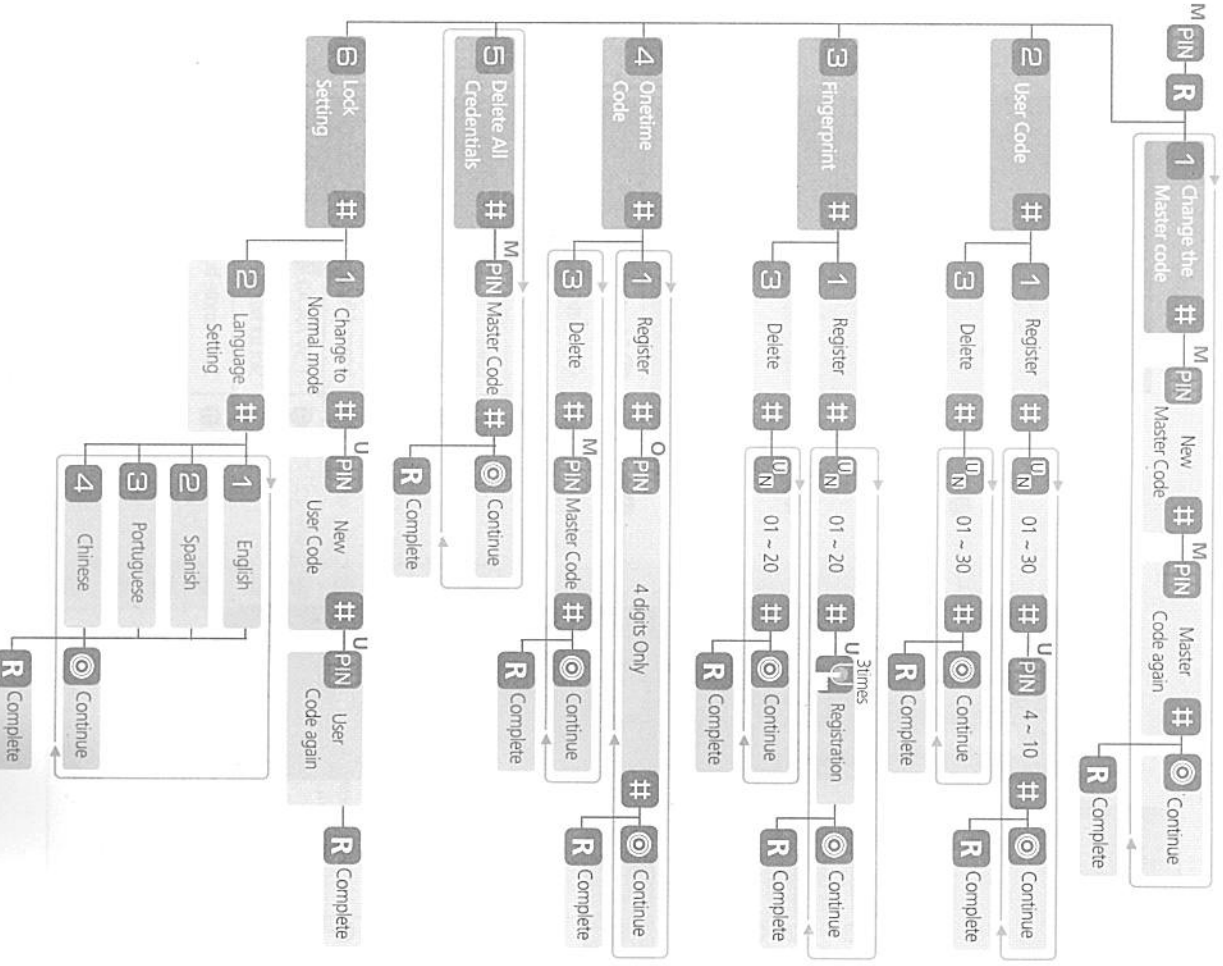

Quick Menu

Advanced mode

Quick Menu (Advanced mode)

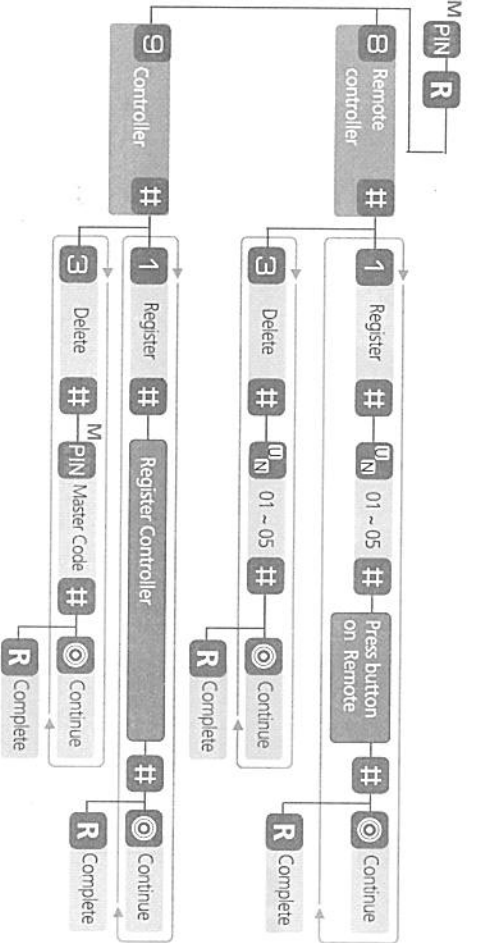

	Touch the keypad of the Front Body with your palm to begin.	M PIN	Enter the Master Code (4 ~ 10 digits).
1	Click the indicated number.	U PIN	Enter User Code (4 ~ 10 digits).
	Press [●] button on the touchscreen.	V PIN	Enter Visitor Code (Only 4 digits).
#	Press [#] button on the touchscreen.	O PIN	Enter Onetime Code (Only 4 digits).
R	Press (R) (Registration) button inside the battery cover.	U	Enter User Fingerprint (Up to 20ea).
	Repeat operation using settings indicated.	U N	User Slot Number should be 2 digits

Note Creating the Master code

Creating a the Master Code must be performed upon installation or after resetting the lock to factory default. Programming and use of Lock is not possible until this step has been successfully completed.

Quick Menu

Normal mode

Quick Menu (Normal mode)

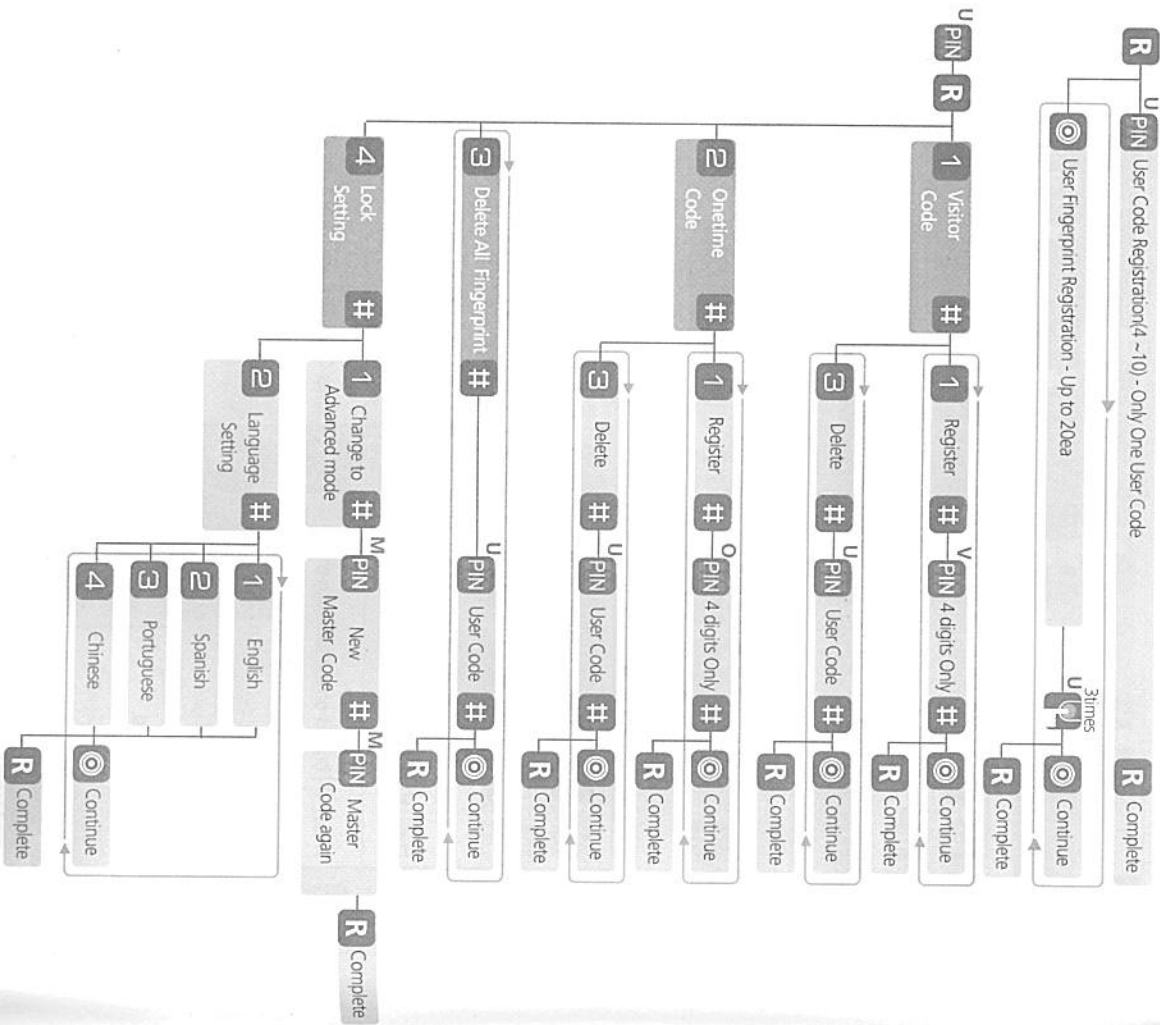

Quick Menu

Normal mode

Quick Menu (Normal mode)

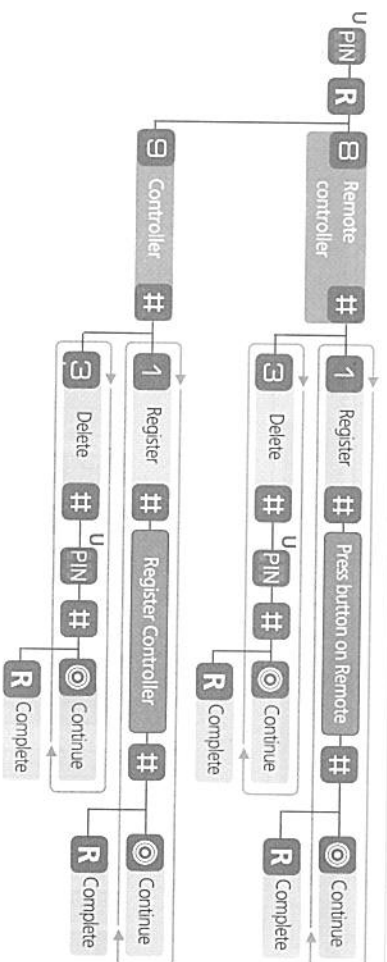

	M PIN	Enter the Master Code (4 ~ 10 digits).
1 ~ 0	U PIN	Enter User Code (4 ~ 10 digits).
	V PIN	Enter Visitor Code (Only 4 digits).
#	O PIN	Enter Onetime Code (Only 4 digits).
	U	Enter User Fingerprint (Up to 20ea).
	U N	Repeat operation using settings indicated.

Configuration

Advanced mode

Change the Master Code

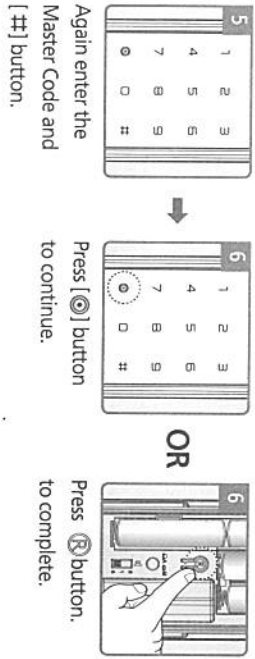
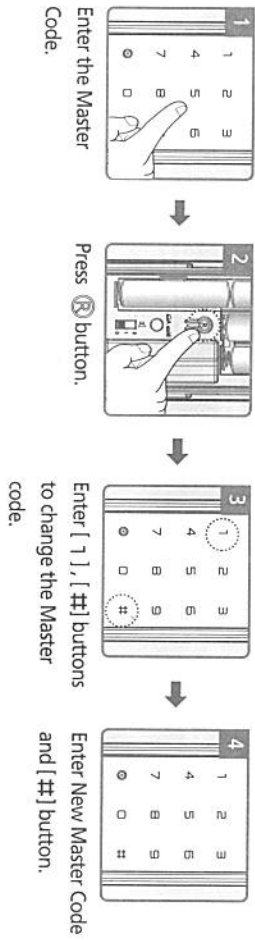

Configuration

Advanced mode

Register User Code

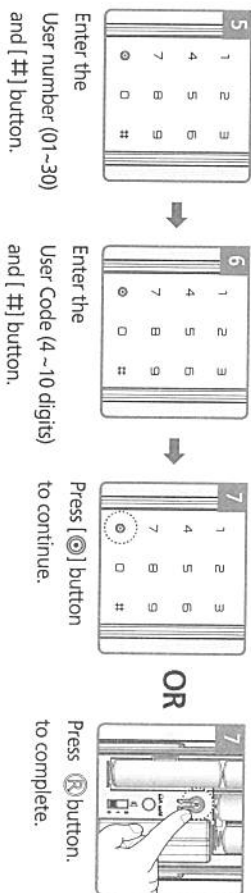
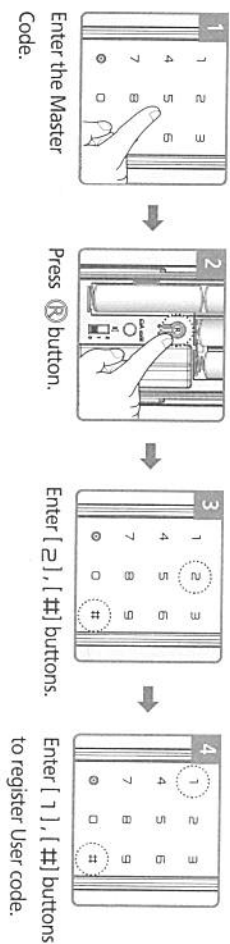

Delete User Code



Configuration

Advanced mode

Register Fingerprint

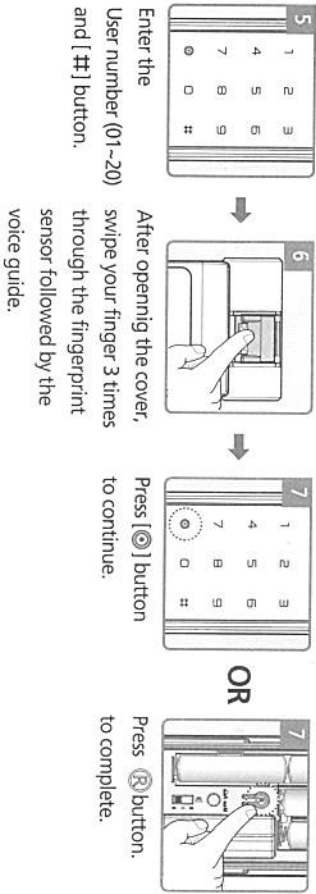
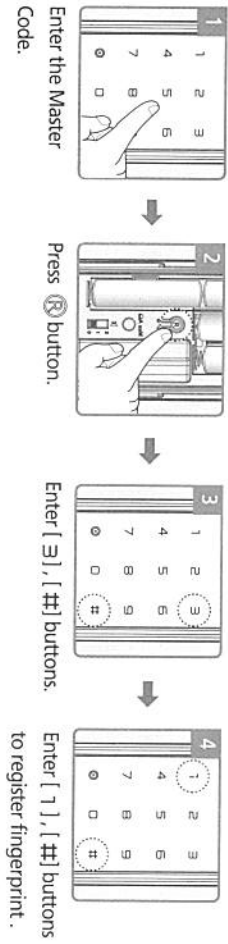
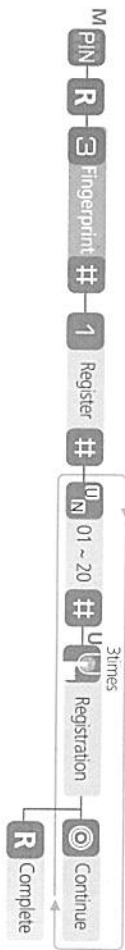

Delete Fingerprint



Configuration

Advanced mode

Register Onetime Code

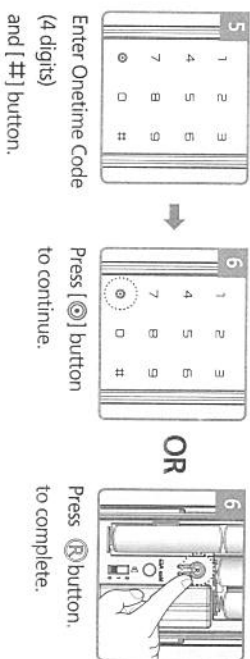
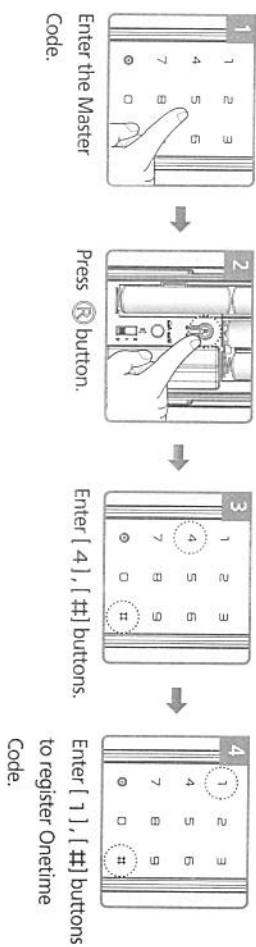

Delete Onetime Code



Configuration

Advanced mode

Delete All Credentials

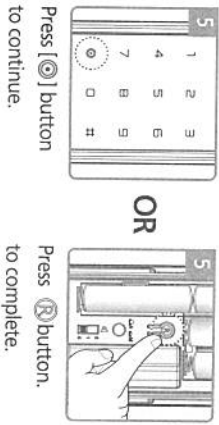
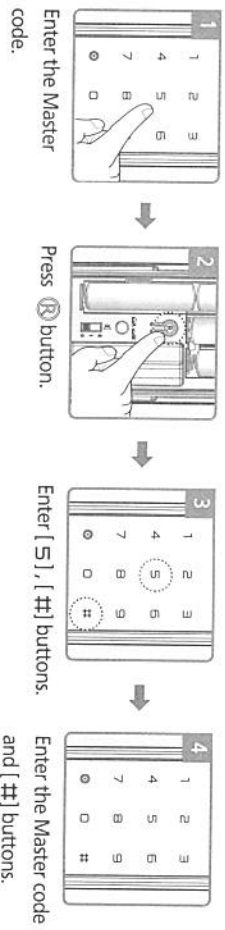

Configuration

Advanced mode

Lock Setting

Change to Normal mode

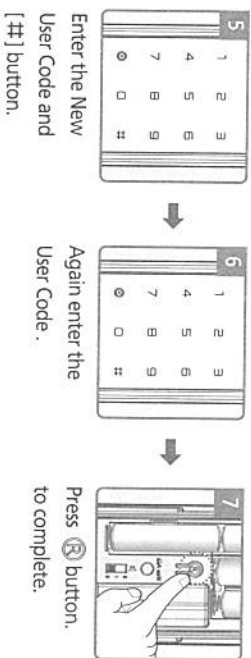
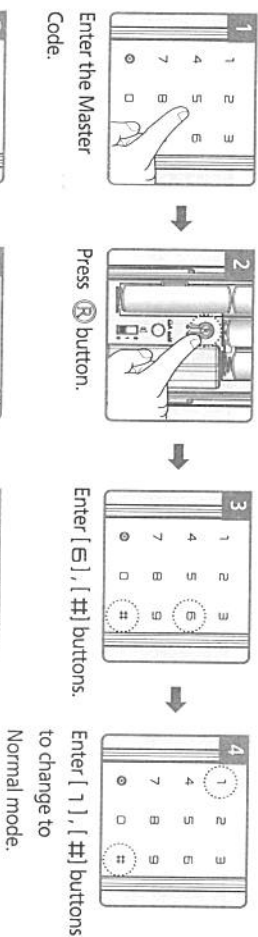
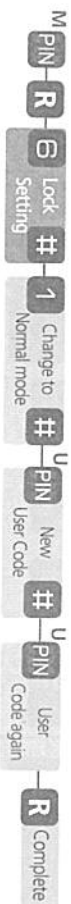

Language Setting

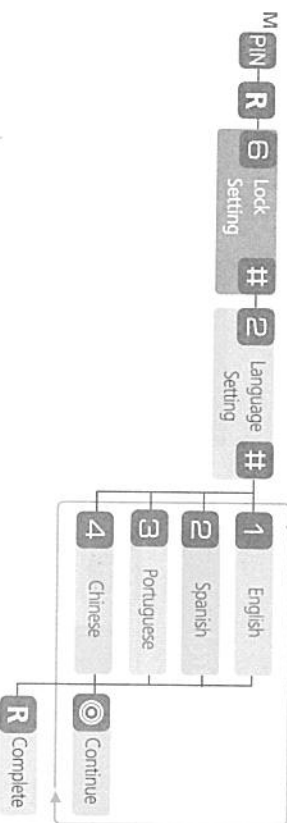

ENGLISH

Configuration

Advanced mode

Register Remote control

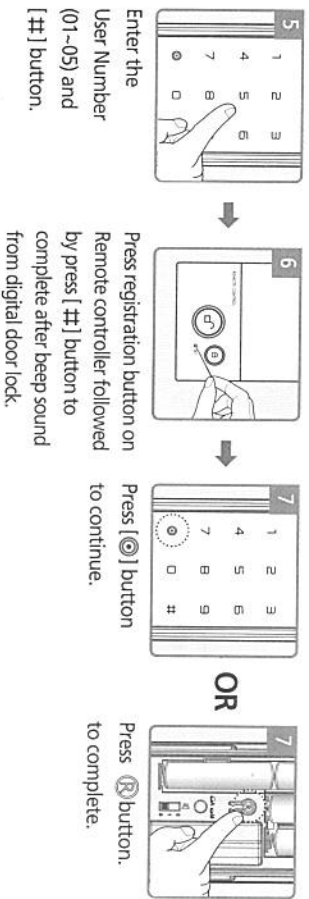
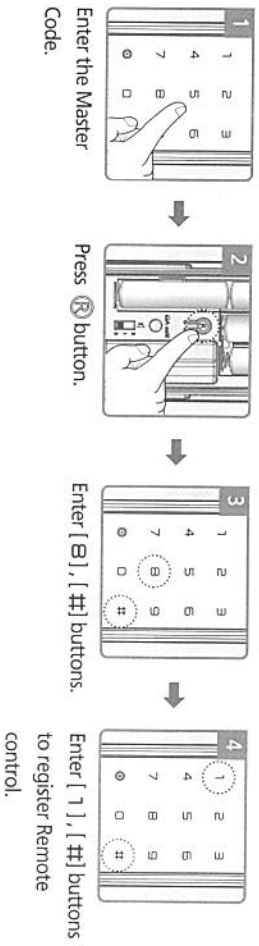
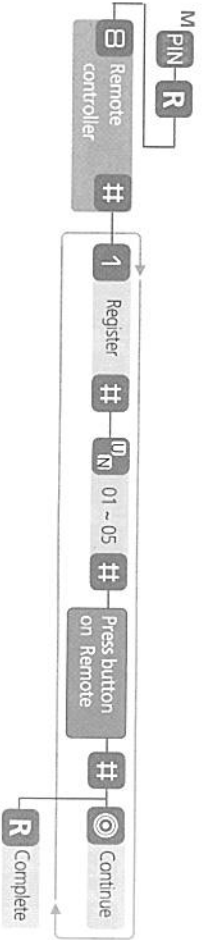

Delete Remote control



Configuration

Advanced mode

Register Controller

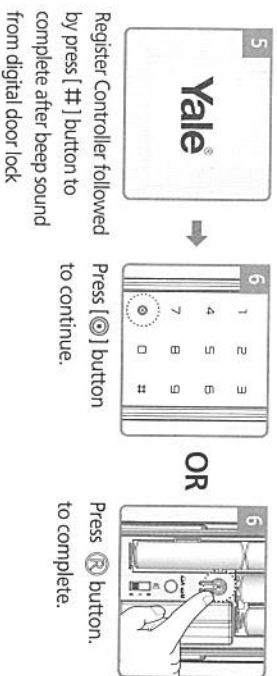
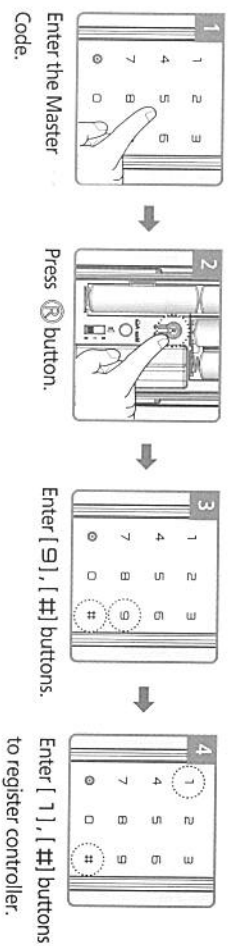
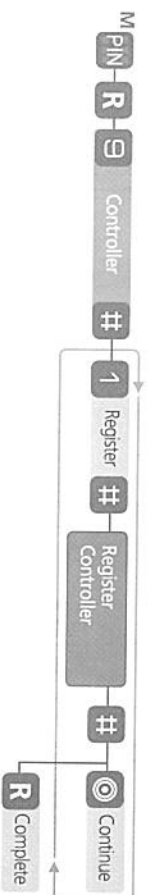

Delete Controller



Configuration

Normal mode

User Code Registration (4 ~ 10 digits)

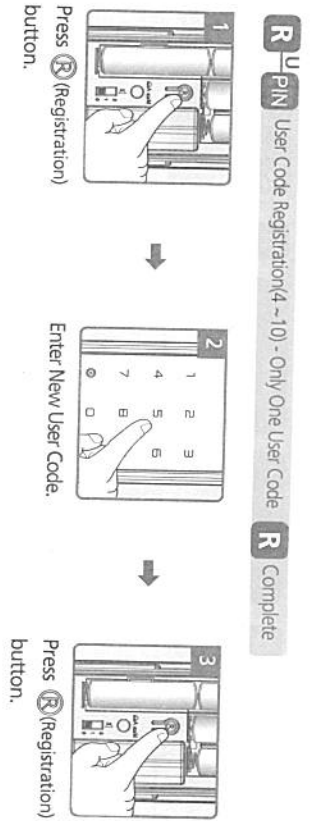

User Fingerprint Registration (Up to 20ea)

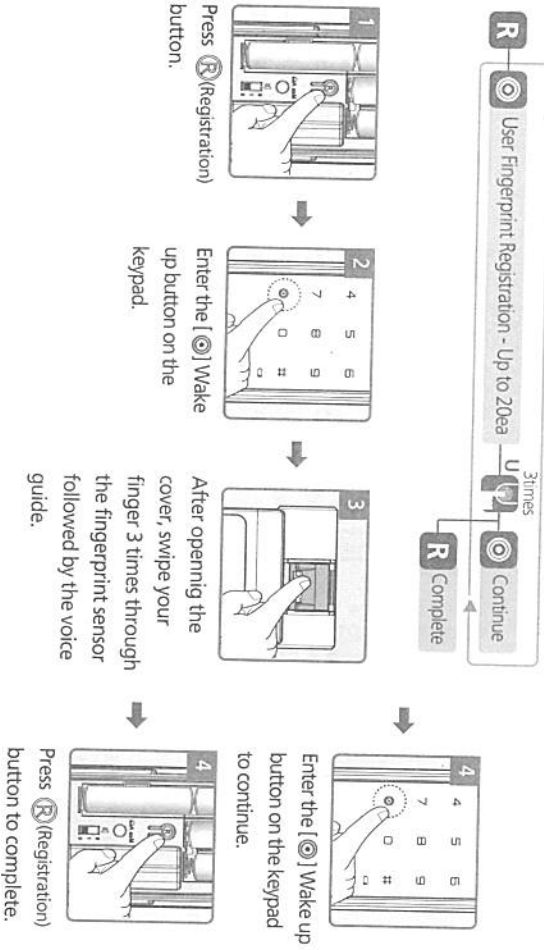

Caution

- Make sure to leave the door open when registering User Code and Fingerprints because you may accidentally lock the door while trying to register or change a credential.
- The previously registered User Code will automatically be deleted when a new credential is registered.
- It is recommended to change User Code on a regular basis.

How to Use

Normal mode

Advanced mode

Unlocking Door with Code

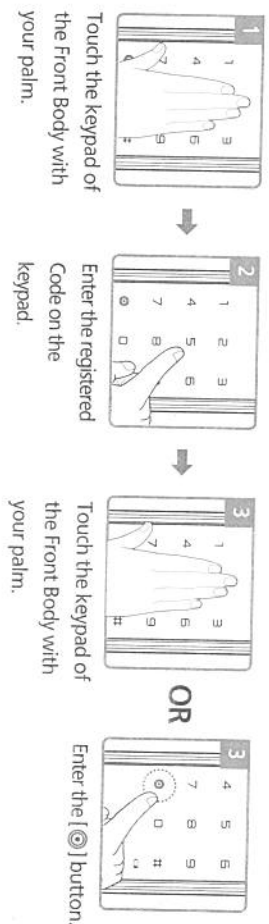

Unlocking Door with Fingerprint

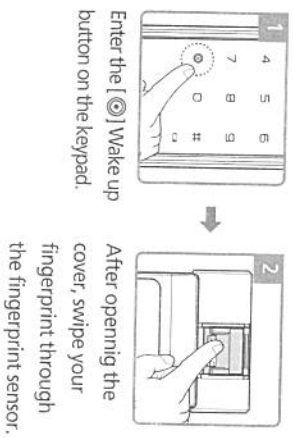

Check if the door opens!



Make sure to examine if the door opens normally with the registered User Code after the registration is complete.

How to Use

Normal mode

Advanced mode

Locking the door

※ Please check Automatic / Manual Lock Mode

» Automatic Lock Mode (Default)

Outside

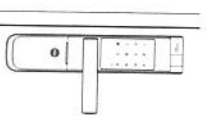

Within 5 seconds

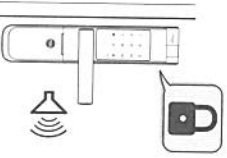

Inside

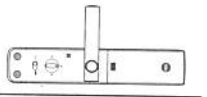

Within 5 seconds

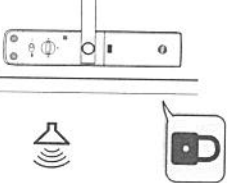

When set on automatic lock mode, the automatic lock sensor detects the door closing and locks the door automatically within 5 seconds.

» Manual Lock Mode

Outside

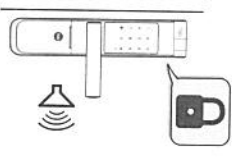
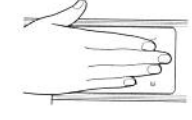

Inside

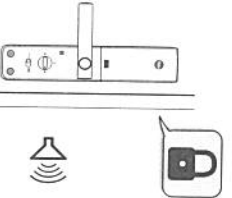
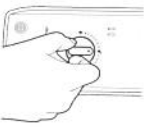

The door locks when touching the keypad with the palm.

Use Thumb turn knob on the main body.

▲ Caution

- As the automatic lock function does not work in manual lock mode, make sure to check that the door is securely locked when leaving the premises.

How to Use

Normal mode

Advanced mode

Unlocking the door from the inside

Safe Handle Setting is not fixed as a default.

» To Open Door when the safe handle button is released.

Keep pushing the safe handle button. And then, press and open the door. The safe handle button is found on the inner handle.



(Closed)



(Open)



» To Open Door when the safe handle button is fixed.

Press the inner handle and open the door.



(Closed)



(Open)

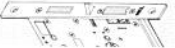

▲ Important

- Make sure to fully familiarize yourself with the operation of the Safe Handle in preparation for emergencies.

How to Use

Normal mode

Advanced mode

Safe Handle Setting

The technology to prevent a forced attempt to drill a hole in the door and unlock the doorlock has been applied.

» To Enable Safe Handle Setting

Turn the fixing screw counterclockwise by Philips screw driver until the safe handle button is released.

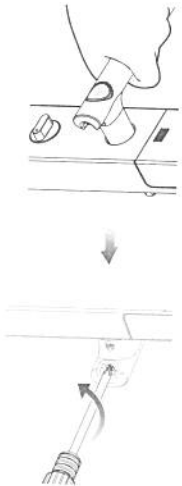

» To Disable Safe Handle Setting (Default Setting)

Turn the fixing screw clockwise by Philips screw driver to fix the button while keeping to push the safe handle button.

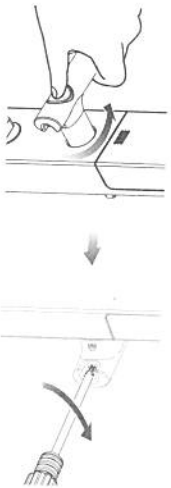

Note

- Be careful that the fixing screw is not separated during the safe handle setting.

How to Use

Normal mode

Opening Door with fake Code

(Only Normal mode)

This is an extra security measure to prevent your Code being accidentally exposed. It is only available for your User and Visitor Code ; not for use with the OneTime Code.

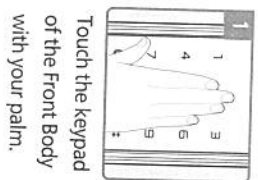

Touch the keypad of the Front Body with your palm.

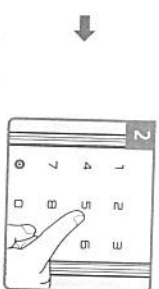

Method ①
Enter the **fake numbers** → **Code**
Method ②
Enter the **Code** → **fake numbers**

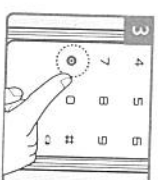

Press [7] button to confirm, or Touch the keypad with palm to confirm.

How to Use

Normal mode

Advanced mode

External Forced Lock

When External Forced Lock mode is activated the Alarm will go off if someone press the handle to exit the property.

External Forced Lock Setting - Fingerprint

Swipe with registered fingerprint and touch the [#] button for 5 seconds until you hear 3 beeps.

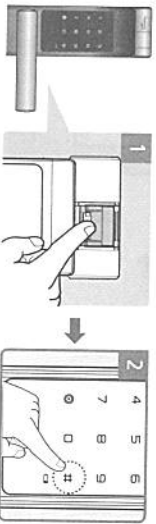

External Forced Lock Setting - User Code (Except Onetime Code)

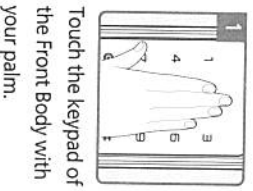

Touch the keypad of the Front Body with your palm.

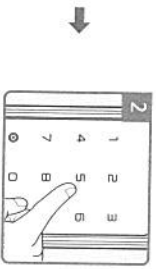

Enter registered User Code on the keypad.

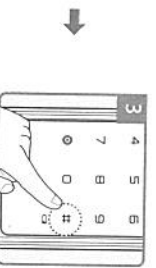

Enter [#] button for 5 seconds. (The beep sound sets off for 3 times.)

Internal Forced Lock

When internal forced lock mode is activated the keypad is not functioning.

A warning beep sound will go off if anyone attempts to access using Code or the Fingerprint from outside.



Note

- If you open a door with the handle from inside in External Forced Lock, the alarm will sound.
- Deactivate External Forced Lock by entering User Code or touching Fingerprint reader with registered Fingerprint.
- Internal Forced Lock is only activated when door is closed.

How to Use

Normal mode

Advanced mode

Automatic / Manual Lock

Default Automatic lock

Automatic Lock Setting

Main body Automatic/Manual Lock button released to set Auto

Manual Lock Setting

Main body Automatic/Manual Lock button pressed to set Manual

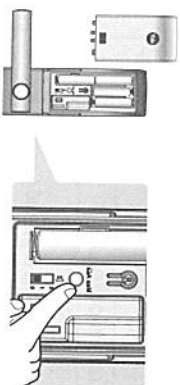

Volume

Default High

0 1 2



The operation sound volume will be adjusted according to the Volume Switch Setting. (2 : High / 1 : Low / 0 : Mute)

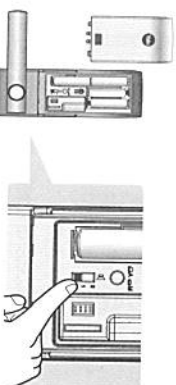

Note

- Even though the operation sound is set to 'Mute', the error and alarm will sound.

How to Use

Normal mode

Advanced mode

Break-in Alarm

Break-in Alarm : When the front body is separated from the door, the damage alarm will sound.

To turn off Alarm

- Method ① Enter the registered Codes.
- Method ② Press the interior  button for 5 seconds.
- Method ③ Enter the registered Fingerprint.

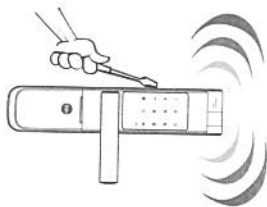

3-minute Lock Out Feature

During the 3-minute Lock Out mode, the lock will shut down and not allow operation.

After five(5) unsuccessful attempts at entering a valid code or fingerprint, 3-minute Lock Out mode is activated.

To Release 3-minute Lock Out

- Method ① Press  button.
- Method ② Depress inside lever handle.

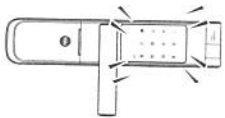

How to Use

Normal mode

Advanced mode

Emergency mechanical key override

Operate the lock with the mechanical key when there is a problem with the lock.

- Such as :
- Forgotten User Code
- Electronic malfunction

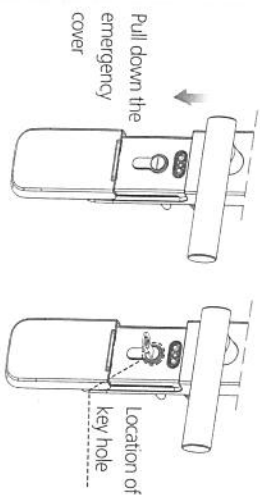

Product malfunction

Press reset button located in the center of [Emergency power terminal] with a finger and try again testing the Fingerprint or the Code. If it still does not work, call the after-sales service.

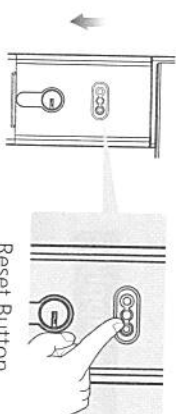

Resetting Lock to Factory Default

When lock is reset to factory defaults all user codes (including the Master code*) are deleted and all programming features are reset to original default settings (See below).

1. Remove the battery cover and batteries.
2. Remove the interior escutcheon to access the reset pads.
3. The reset pads are located on bottom of the PCB board (See image)
4. While pressing the reset pads with tweezers, reinstall batteries and release reset pads with tweezers.
5. Replace battery cover.

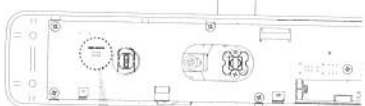

Reset Button

Upon reset, the Master Code creation is the only option available and must be performed prior to any other programming of the lock.

Emergency Power

Emergency power supply for discharged batteries

In case the batteries are dead, you can open the door by using 9V battery as shown.

› To supply emergency power

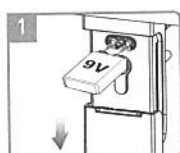

1 Place the 9V battery onto the emergency power supply terminal.

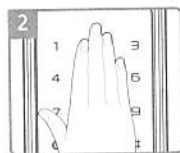

2 Touch the keypad with your palm.

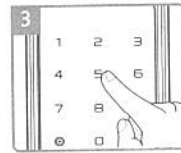

3 Enter the registered Code on the keypad.

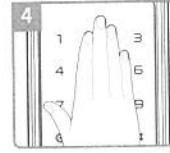

4 Touch the keypad with palm or Press [*] to confirm and replace the batteries

Power supply

1 Expiry period

The product uses four 1.5V alkaline AA batteries. They may sustain 1 year if used 10 times a day. (Users are advised to use authentic alkaline batteries.)

One-on-one real-life size

1.5V(LR6) alkaline AA battery

2 Low battery alarm

You must replace all 4 batteries in the following cases:

- * The Low Battery LED on key pad flickers red.
- * When low battery notification message is played.

RISK OF EXPLOSION IF BATTERY IS REPLACED BY AN INCORRECT TYPE. DISPOSE OF USED BATTERIES ACCORDING TO THE NATIONAL CODE OR RECYCLING PROGRAM

Low battery lamp (red)

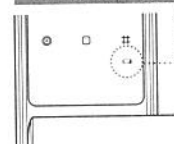

Note

- The battery life varies according to ambient temperature, humidity, the frequency of use, and the quality of the batteries.
- Do not use rechargeable batteries. Only alkaline batteries are recommended.